



Installation Guidelines for EcoDomo Echelon Collection

RECYCLED LEATHER TILES AND SHEETS

RELEASE ADHESIVE INSTRUCTIONS - FLOORS ONLY

You must read and understand these instructions completely before installing EcoDomo Recycled Leather Tile. In the event these instructions leave unanswered questions or if you would like additional information, please contact EcoDomo at 301-424-7717 prior to beginning installation. It is the responsibility of the installer to determine suitability of EcoDomo Recycled Leather Tile for each application. Prior to installation, installer should inspect all material.

Any defect must be reported directly to EcoDomo. Should an individual piece of material be doubtful as to appearance or dimension the installer should not use the piece in question.

PREPARATION

Tiles are the last thing you want to install in a room. Take the tiles **out of their boxes and remove from plastic** and let them acclimate in the room designated for installation as described above. When acclimating tiles, please fan them, opening the areas between the tiles to allow air flow, keep tiles flat during process.

ALLOW THE TILES TO ACCLIMATE OUT OF THE BOX, FANNED OUT AND ON-SITE, FOR A PERIOD OF 48-72 HOURS AT ROOM TEMPERATURE DEPENDING ON SITE AND LOCATION. Never install tiles below 55F (12°C) and 90F (32°C) due to humidity. Keep the doors closed during the acclimation period to maintain the room temperature. The permanent HVAC should be on and done in the environment in which it is expected to perform prior to installation.

- Remove furniture and appliances using a piece of hardboard to protect the floor.
- Check that the wood is firmly fastened to the original subfloor.
- Repair any knotholes, indentations or open joints with Ardex® Feather Finish or like.
- Use a belt sander or sanding block to smooth out any rough areas
- The prepared sub floor must be smooth, clean, dry and dust-free.

We recommend the application of Kilz water based General Purpose Latex Primer in a matching color in order to seal the substrate and limit dust and moisture variation. This is a similar process to sealing a wall when installing wallpaper.

Flooring must not be installed if vapor pressure exceeds 3 lbs. per 1000 square feet in 24 hours as tested according to ASTM F 1869 (calcium chloride test method). Preferably the slab should be tested according to ASTM F 2170 (Standard Test Method for Determining Relative Humidity in Concrete Floor Slabs Using In Situ Probes) Flooring must not be installed if the relative humidity inside of the concrete slab exceeds 75%.

Follow the release adhesive manufacturer specific additional for the substrate preparation. The adhesive manufacturer, warranties their adhesive for replacement costs including materials and labor. You can contact them to have a technician provide an on-site short training at no cost *and* to see the installation video ahead of working with their product. Please contact us for details ahead of the installation.



INSTALLATION

- Find the center point between the two longest parallel walls. Mark guidelines from centers of opposite walls.
- Lay rows of Recycled Leather Tiles in both directions from the center, adjusting to give the most balanced cutting at the perimeter of room.
- Apply the release adhesive per the manufacturer's instructions on the floor. You simply have to spray in an even pattern with the adhesive. Each can covers approximately 200 square feet. There is no need to apply adhesive on the leather tiles.
- Starting where the perpendicular lines cross, place the first tile into place. Make sure edges are flush with the chalk lines. When positioned correctly press down firmly.
- Lay all full Recycled Leather Tiles in step fashion, starting in center of room.

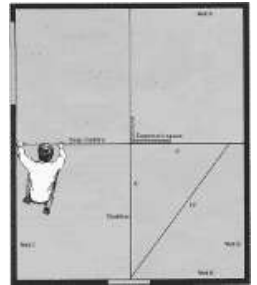

Fitting Partial Recycled Leather Tiles

- To fit partial Recycled Leather Tiles, lay the tile to be cut exactly over the last full tile; place another full tile against the wall and mark the cutting line where the Recycled Leather Tiles overlap.
- Cut tile on line. Check that the cut tile fits and press firmly into position. Do not force it in place.



Finishing Up

- When finished installing, roll the floor twice with a (min.) 125 pound roller to make sure Recycled Leather Tiles are firmly in place down. The adhesive is *pressure sensitive*; rolling the floor is essential to ensure proper adhesion. Again, follow the instructions of the adhesive manufacturer.
- Replace baseboard molding.

TOPICAL SEALER - FOR FLOORS ONLY

Once installed, a topical sealer should be applied for added protection and wear layer on your recycled leather tiles. You can use for :

- **COMMERCIAL APPLICATIONS :** VERMEISTER® HI TECH 2K – Gloss from 10-30 two component waterborne Polyurethane finish. This is especially desirable in commercial applications and provides not only a urethane finish but is also ADA compliant. This can be obtained from any Vermeister ® distributor.
- **RESIDENTIAL :** Butcher's® Bowling Alley Wax or TreWax® No Slip Wax

**** THE RELEASE ADHESIVE IS NOT RECOMMENDED FOR WALL APPLICATIONS ****



EcoDomo

Additional General Installation Instructions

Thank you for choosing leather or cork tiles, a natural product. The tiles, like wood, bamboo, or cork may absorb moisture and need to acclimate to their surrounding environment prior to installation. Please carefully read and follow these instructions. A professional installer with experience with cork, hardwood or vinyl flooring is recommended to install leather flooring

I. GENERAL SITE CONDITIONS

- When flooring is ordered, 5% must be added to the actual square footage needed for cutting and other waste factors (10% for diagonal installations). Inspection of all flooring should be done prior to installation. Carefully examine flooring for color, finish and quality before installing it. If material is not acceptable, do not install it and contact the seller immediately.
- Prior to installation of any flooring product, the owner/installer must determine that the job-site environment and the sub-surfaces involved meet or exceed all applicable standards. Recommendations of the construction and materials industries, as well as local codes, must be followed. These instructions recommend that the construction and subfloor be clean, dry, stiff, structurally sound and flat. The manufacturer declines any responsibility for job failure resulting from, or associated with, subfloor and substrates or job-site environmental deficiencies.

II. PREPARATION

Storage and Handling

Handle and unload with care. Store in a dry place, being sure to provide at least a four-inch air space under cartons which are stored upon “on-grade” concrete floors. Flooring should not be delivered until the building has been enclosed with windows, doors are in place, and cement work, plastering and all other “wet” work is completed and dry. **Acclimate as directed prior to installation.** This must be done in the environment in which it is expected to perform prior to installation.

Check adhesive label for adhesive storage limitations.

Job-Site Conditions

- The building should be enclosed with all outside doors and windows in place. All concrete, masonry, framing members, drywall, paint and other “wet” work should be thoroughly dry. The wall coverings should be in place and the painting completed, except for the final coat on the base molding. When possible, delay installation of base molding until flooring installation is complete. Basements and crawl spaces must be dry and well ventilated.
- Exterior grading should be complete with surface drainage, offering a minimum drop of 3” in 10’ (7.6 cm in 3.05 m) to direct flow of water away from the structure. All gutters and downspouts should be in place.
- Echelon and Classic Cork glue-down flooring may be installed on- or above-grade level. Do not install in full bathrooms.
- Crawl spaces must be a minimum of 18” (46 cm) from the ground to the underside of the joists. A ground cover of 6–20 mil black polyethylene film is essential as a vapor retarder with joints lapped 6” (15 cm) and sealed with moisture-resistant tape. The crawl space should have perimeter venting equal to a minimum of 1.5% of the crawl space square footage. These vents should be properly located to foster cross ventilation.



- Permanent air conditioning and heating systems should be in place and operational. The installation site should have a consistent room temperature of 60 –80°F (16–27°C) and humidity of 35-55% for 14 days prior to and during installation and until occupied.

WARNING: IF THERE ARE EXISTING IN-PLACE RESILIENT FLOOR COVERING AND ASPHALTIC ADHESIVES: DO NOT SAND, DRY SWEEP, DRY SCRAPE, DRILL, SAW, BEADBLAST, OR MECHANICALLY CHIP OR PULVERIZE EXISTING RESILIENT FLOORING, BACKING, LINING FELT, ASPHALTIC “CUTBACK” ADHESIVE, OR OTHER ADHESIVE. These existing in-place products may contain asbestos fibers and/or crystalline silica. Avoid creating dust. Inhalation of such dust is a cancer and respiratory tract hazard.

Unless positively certain that the existing in-place product is a non-asbestos-containing material, you must presume it contains asbestos. Regulations may require that the material be tested to determine asbestos content and may govern removal and disposal of material. See current edition of the Resilient Floor Covering Institute (RFCI) publication Recommended Work Practices for Removal of Resilient Floor Coverings for instructions on removing all resilient floor covering.

Eco Domo products and recommended adhesives do NOT contain asbestos.

Subfloor Conditions

- **CLEAN**—Subfloor must be free of wax, oil, sealers, adhesives and other debris.
- **LEVEL/FLAT**—Within 3/16” in 10’ (5 mm in 3 m) and/or 1/8” in 6’ (3 mm in 2 m). Sand high areas or joints and fill low areas with Ardex Feather Finish. Follow the instructions of the leveling compound manufacturer but make certain that the leveling compounds are completely DRY before beginning installation.
- **DRY**—Check and document moisture content of the subfloor using the appropriate moisture test.
- **STRUCTURALLY SOUND**—Nail or screw any areas that are loose or squeak. Wood panels should exhibit an adequate fastening pattern, glued/screwed or nailed as system requires, using an acceptable nailing pattern. Typical: 6” (15 cm) along bearing edges and 12” (31 cm) along intermediate supports. Flatten edge swell as necessary. Replace any water-damaged, swollen or delaminated subflooring or underlayment.
- Underlayment will need to be minimum of ¼ “or thicker with one fully sanded face (APA Underlayment Grade plywood or equal). Underlayment must be free of any material that would interfere with providing a secure bond or that would cause discoloration (adhesives, solvents, inks, sealers, etc.). EcoDomo does not recommend installation over particle or chip board, tempered hardboard, fire retardant plywood, or pressure treated plywood unless special considerations are reviewed with EcoDomo prior to installation.
- Avoid subfloors with excessive vertical movement. If the subfloor has excessive vertical movement (deflection) before installation of the flooring, it is likely it will do so after installation of the flooring is complete.

Subfloors with Radiant Heat:

* We do not recommend the use of a release adhesive over radiant heat systems with our product lines. We suggest you use the Echelon Glue Down Method or the EcoDomo Rainforest Collection planks and tiles for the use of recycled leather over radiant heat.



III. SUBFLOOR/UNDERLAYMENT REQUIREMENTS

Recommended Subfloor/Underlayment Surfaces

- Concrete • Ceramic Tile, Terrazzo, Slate & Marble
- Wood subfloors • Wood structural panels and underlayment • Fully adhered existing wood floors

Concrete : The flooring can be glued directly to concrete with a minimum compressive strength of 3000 PSI. Do not install over a concrete sealer. If present, remove by grinding or sanding.

If using underlayment to correct deficiencies in the subfloor and to provide a smooth sound surface on which to install the recycled leather or cork tiles, be sure to acclimate panels to site conditions before installation

Ceramic, Terrazzo, Slate & Marble (Glue-Down or Floating Only)

If you are installing the leather or cork tile over existing ceramic tile, use a self-leveling compound such as Ardex® Feather Finish or like to ensure an even surface. Old grout lines **MUST** be filled. The substance must be smooth, flat and dry before installation . Loose tiles must be re-adhered to the subfloor or filled as above. Remove all sealers and surface treatments. Always check for adequate adhesive bond.

Acoustic Rubber Underlayment

The flooring can be glued or directly over full-spread, permanently bonded acoustic rubber underlayment or underlayment installed with double faced tape. Contact EcoDomo for specifications.

Wood Subfloors and Underlayment (All Installation Methods)

The wood subflooring materials must not exceed 12% moisture content. Using a reliable wood moisture meter, measure moisture content of both the subfloor and the hardwood flooring to determine proper moisture content.

Applicable standards and recommendations of the construction and materials industries must be met or exceeded.